



145 The Crescent, Woodlands , Doncaster, DN6 7RF

This maintained three-bedroom mid-terraced home is an excellent opportunity for first-time buyers, families, or investors alike. With a spacious lounge, modern kitchen and bathroom, and the added convenience of off-road parking, the property combines comfort, practicality, and style.

On the ground floor, you are welcomed by the modern fitted kitchen, leading into the bright and airy lounge perfect for both relaxing and entertaining. The modern fitted kitchen offers ample storage and workspace, ideal for family living and home cooking. Upstairs, the property features three well-proportioned bedrooms and a contemporary family bathroom.

Externally, the property benefits from off-road parking to the front.

The property is ideally positioned close to a wide range of local amenities including shops, schools, and leisure facilities, with excellent transport links nearby for commuters. This makes it a fantastic home for families seeking both comfort and convenience.

With no onward chain, this property is ready for its new owners. Early viewing is strongly advised – contact us today to arrange your appointment.

Guide price £115,000

145 The Crescent, Woodlands , Doncaster, DN6 7RF



- Three generously sized bedrooms
- Off-road parking to the front
- Close to all local amenities
- EPC Rating: D
- Spacious lounge filled with natural light
- Lovely family home in a convenient location
- Great motorway links to A1/M18 motorway
- Modern kitchen and family bathroom
- No onward chain – ready to move straight into
- Council Tax Band: A

Kitchen/Diner

10'5" x 11'7" (3.20 x 3.54)

Storage

Storage

Lounge

12'6" x 17'8" (3.83 x 5.40)

Porch

8'10" x 2'10" (2.71 x 0.87)

Master bedroom

12'11" x 8'7" (3.95 x 2.62)

Bedroom 2

10'5" x 8'7" (3.19 x 2.64)

Bedroom 3

9'3" x 8'7" (2.82 x 2.63)

Bathroom

7'3" x 8'4" (2.22 x 2.55)



Directions

Woodlands is a model village 4 miles (6 km) north-west of Doncaster in South Yorkshire, England. The village lies adjacent to Highfields and Adwick le Street within the City of Doncaster. Woodlands schools are Woodlands Infants School, and Woodlands Junior School, which are now known as Woodlands Primary School. There's also Adwick infant and Adwick primary school, and St Joseph & St Teresa's school which is an infant and primary catholic school. Outwood Academy Adwick is the only secondary school in the area.





Floor Plan

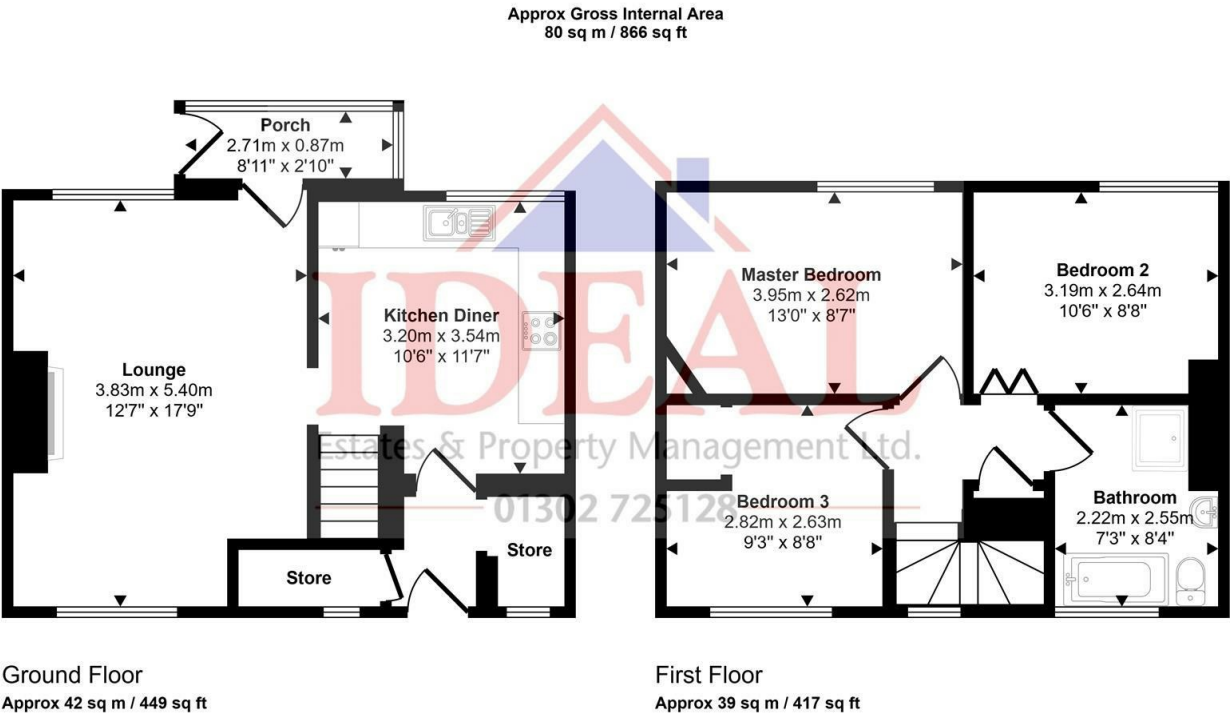

This floorplan is only for illustrative purposes and is not to scale. Measurements of rooms, doors, windows, and any items are approximate and no responsibility is taken for any error, omission or mis-statement. Icons of items such as bathroom suites are representations only and may not look like the real items. Made with Made Snappy 360.

These particulars, whilst believed to be accurate are set out as a general outline only for guidance and do not constitute any part of an offer or contract. Intending purchasers should not rely on them as statements of representation of fact, but must satisfy themselves by inspection or otherwise as to their accuracy. No person in this firms employment has the authority to make or give any representation or warranty in respect of the property.

